

LTECH

E61 Wireless Knob Panel

(Power Mode)



Manual

www.ltech-led.com

System Diagram

LTECH

L-BUS

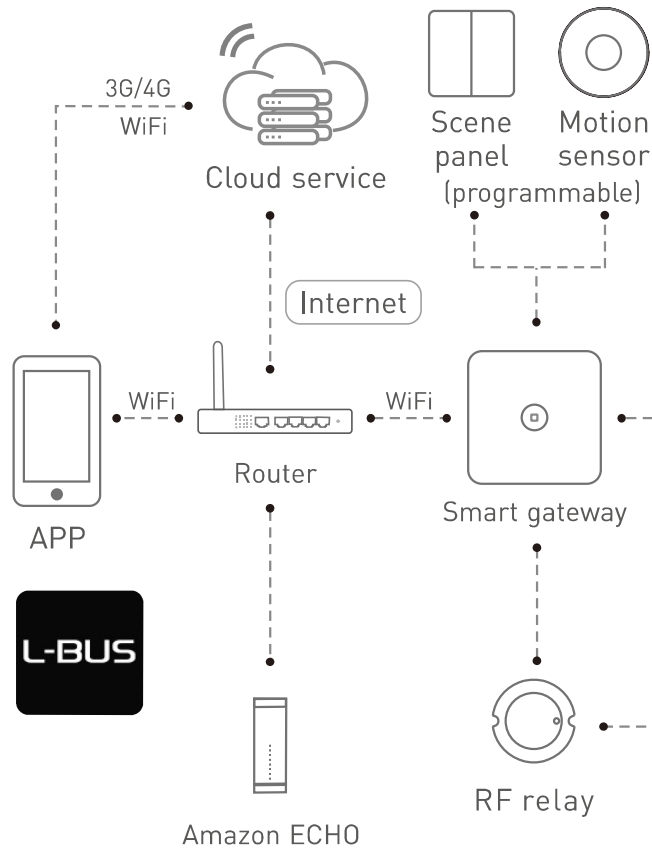

— Wired connection
 - - - - - Wireless connection

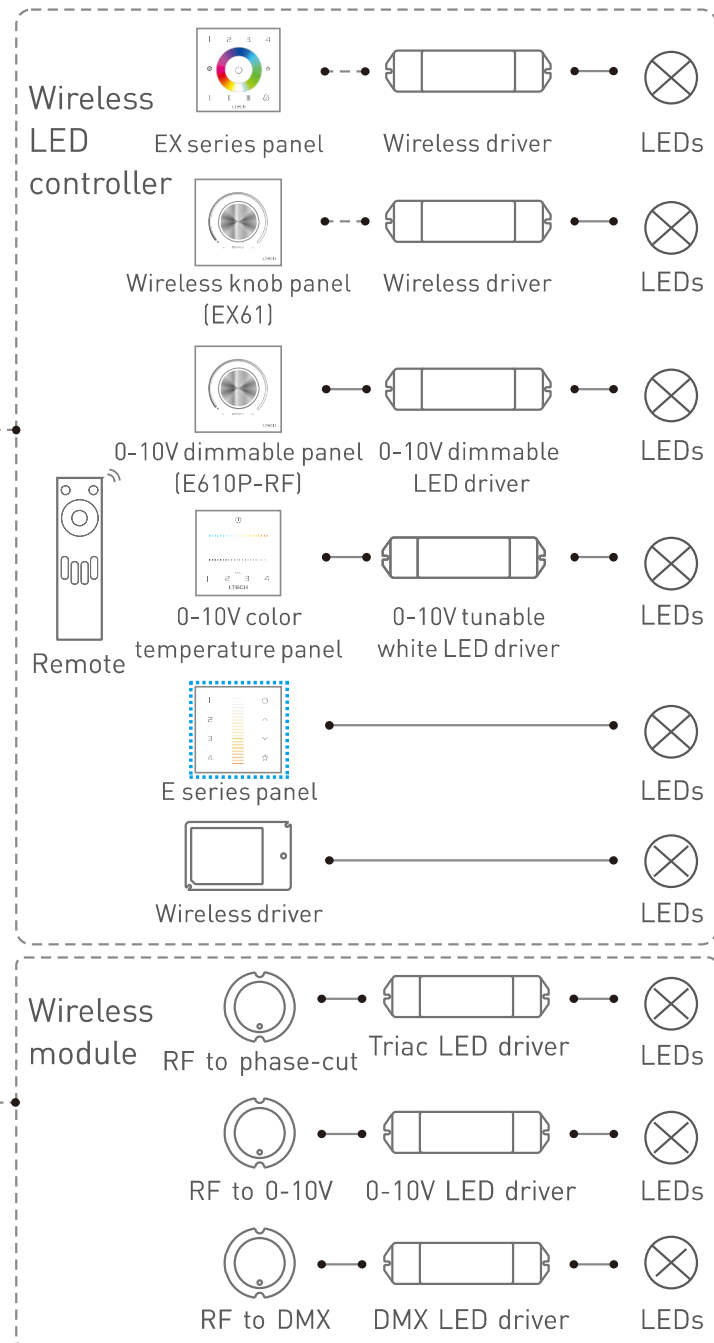

Product Features



- 2 in 1 function: RF wireless control and PWM power output.
- Power output, lamps can be connected directly, easy and convenient.
- With 2 functions: dimming and switch.
- Touch panel can be controlled by remote directly or smart phone if add a gateway.

Technical Specs

E61 Dimming knob panel

Input Voltage:	12-24Vdc	Working Temp.:	-10°C~55°C
Wireless Type:	RF 2.4GHz	Dimensions:	86×86×36mm(L×W×H)
Output Current :	6A×1CH	Package Size:	113×112×50mm(L×W×H)
Output Power:	0~72W...144W	Weight(G.W.):	235g
Protection:	Short circuit / over current		

Product Size

Unit: mm

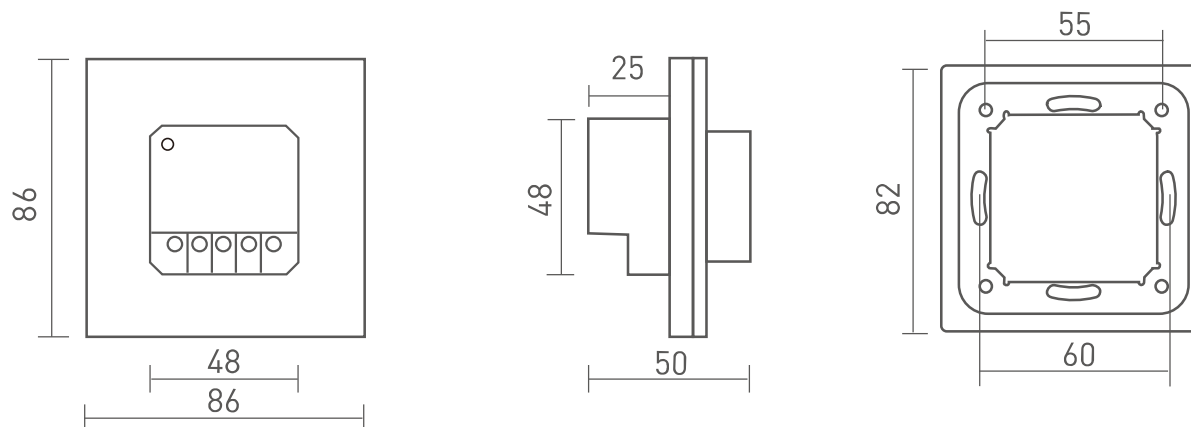

Key Functions

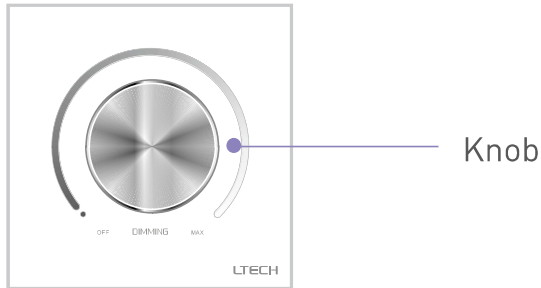

- * Turn the knob clockwise, the brightness increases.
- * Turn the knob counterclockwise, the brightness decreases. Turn the knob counterclockwise to the end, the dimmer will be turned off (A click can be heard).

Terminals

LTECH

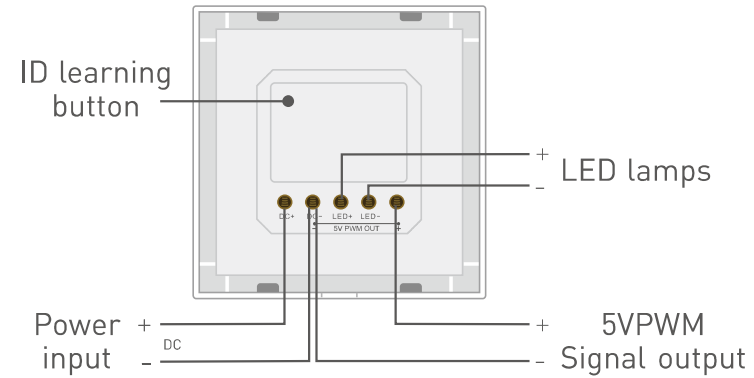

Installation Instructions

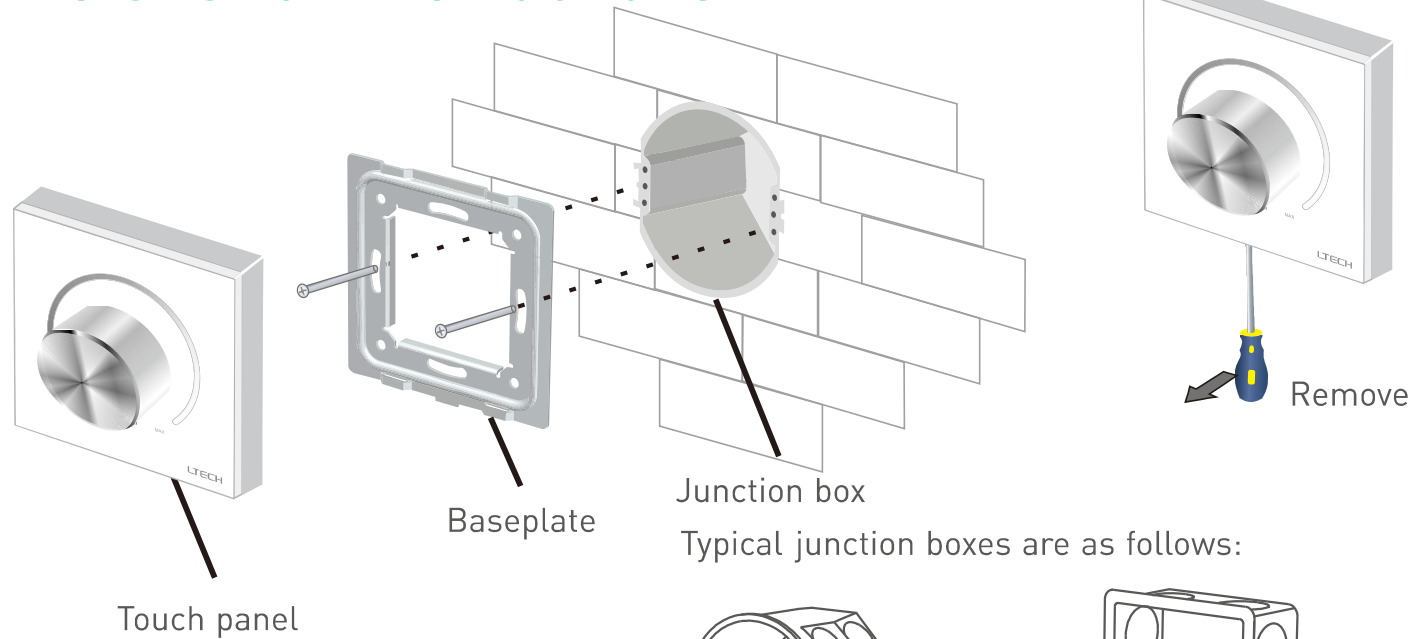

Typical junction boxes are as follows:

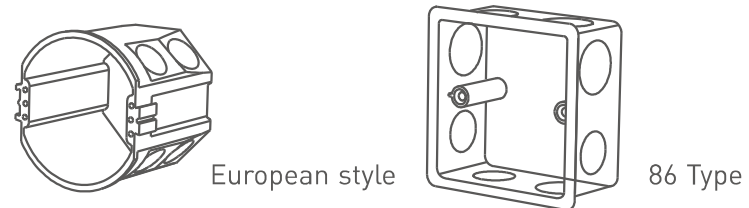

Application Composition

LTECH

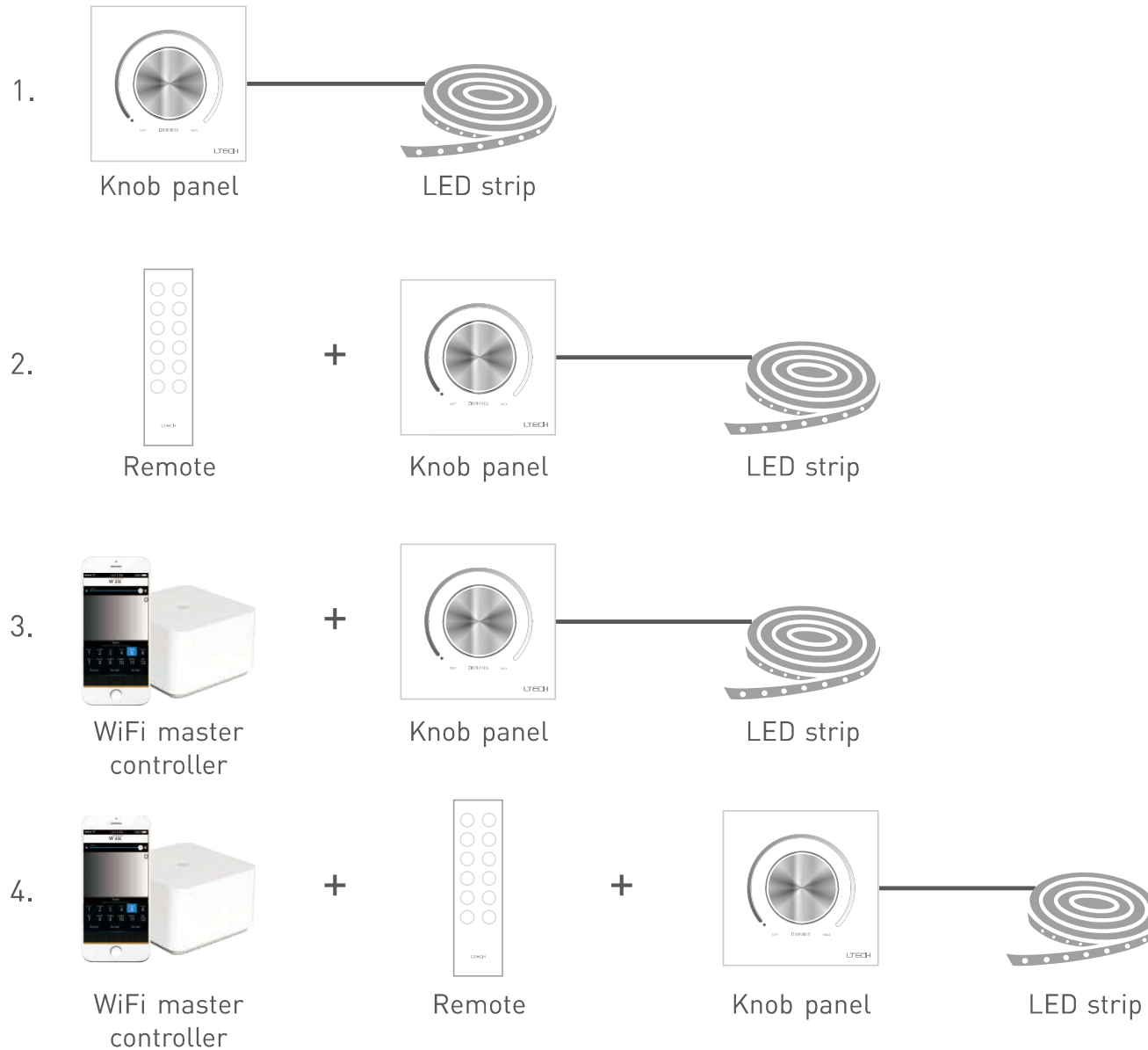

FC CE RoHS [5-Year Warranty]

Wiring Diagram

Connect with 12V strip, Max. 72W; connect with 24V strip, Max. 144W.

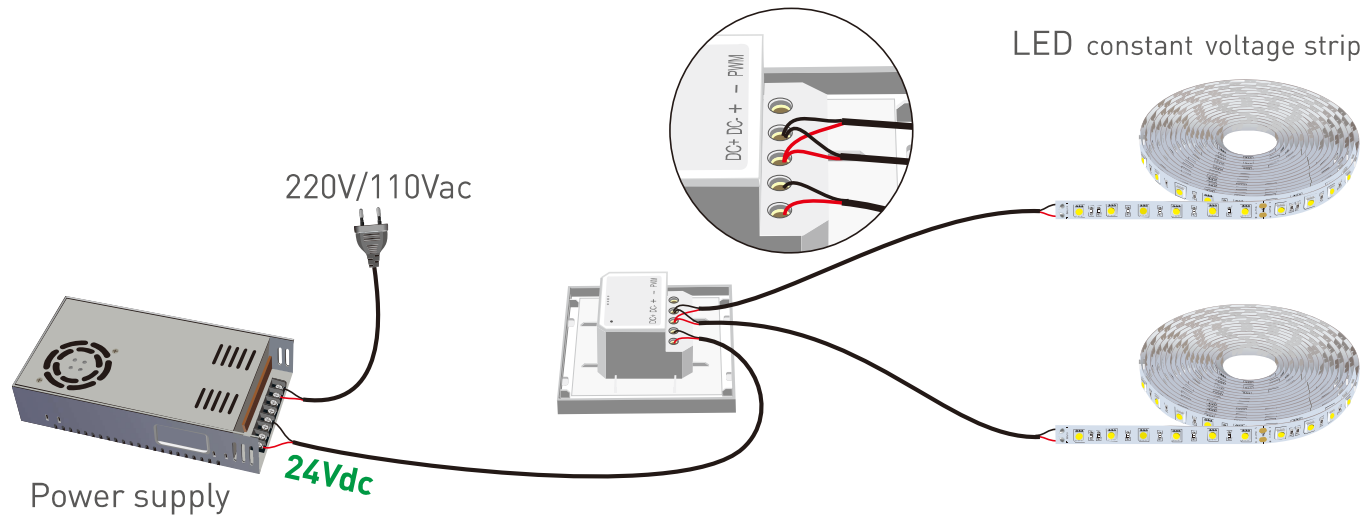

5V PWM Signal Output

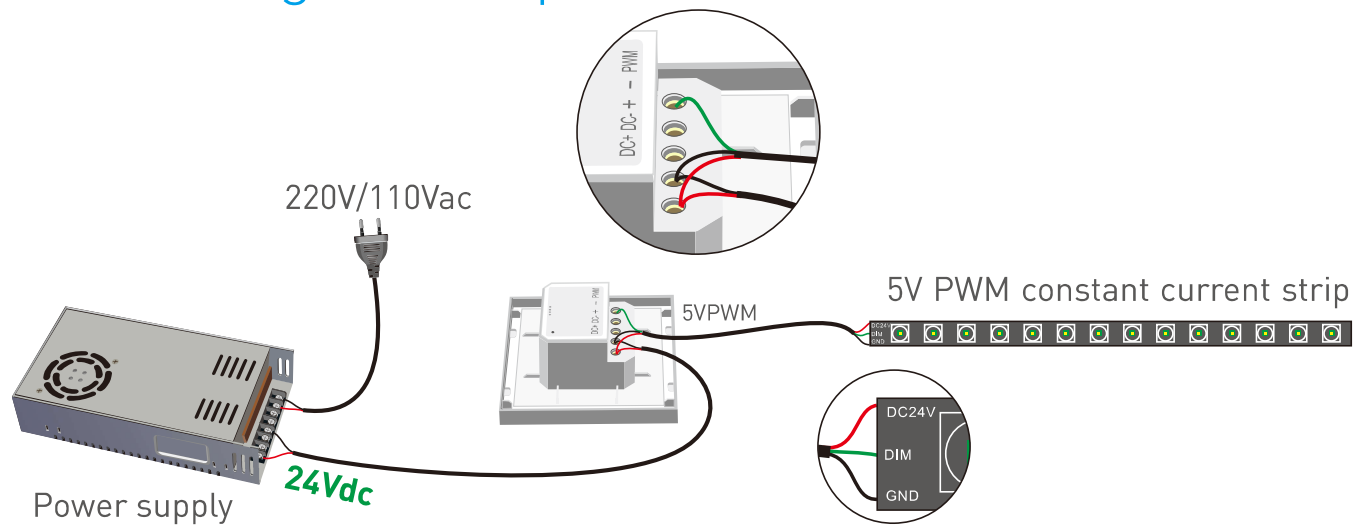

Match Code Sequence

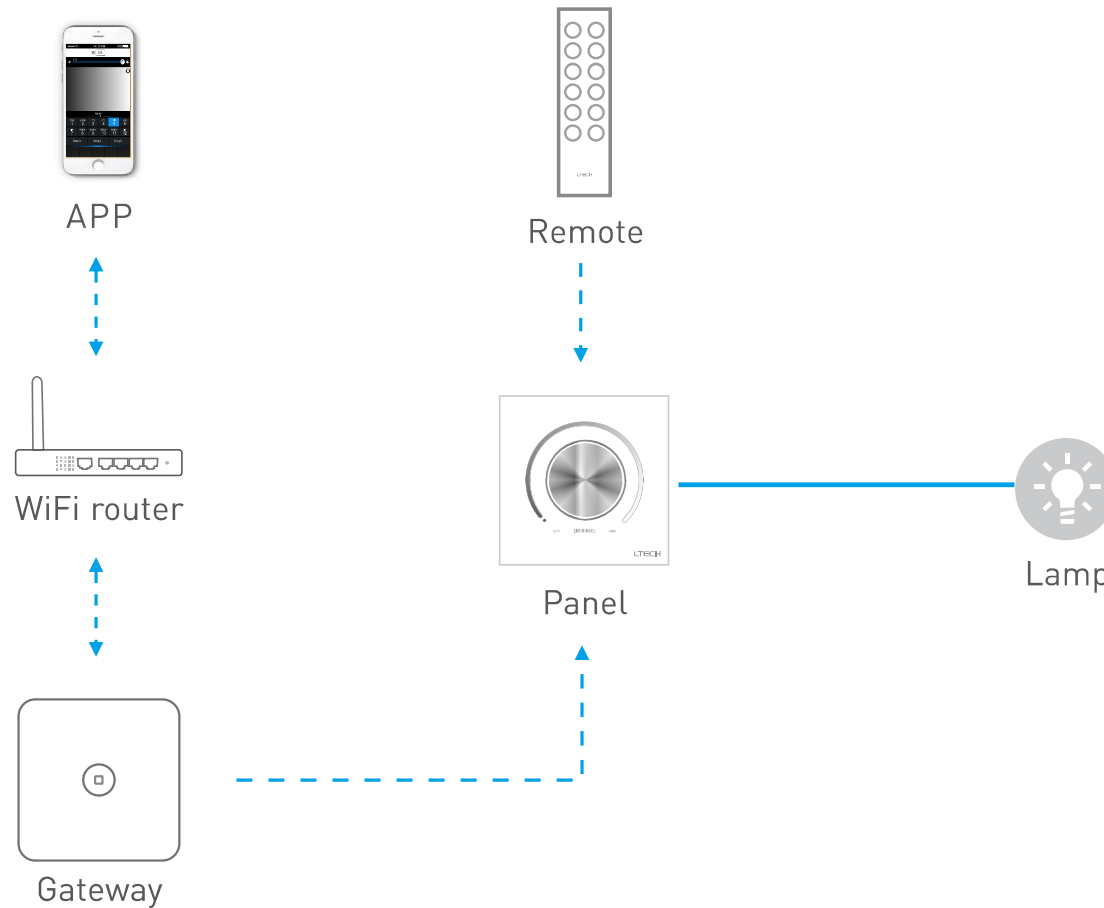

* PS: No WiFi router is needed when gateway work with phones directly.

Match Code Sequence

1. Gateway match up with panel, which enables the smart phone to control lamps via gateway.
2. Remote match up with panel, which enables remote to control lamps.

Match Code between Panel & Remote **LTECH**

1. Short press "ID learning button" on E61, the lamps flash.

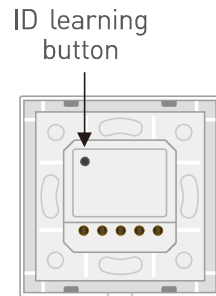

2. Hold down On/Off key on F1, or hold down the matching zone's On & Off keys on F5 simultaneously, if the lamp flashes quickly then back to normal, match successfully.



- * Exit match status automatically if over 15 seconds.
- * One E61 can be matched with max 10 remotes.

Match Code between Panel & Gateway

1. Press ID learning button at the back of the panel.

ID learning button

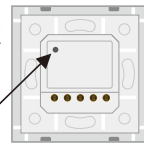

2. Turn on APP, enter "zone set" interface.



3. Click the right top "MATCH" key, then operate following the prompts.



Clear Code

Long press "ID learning button" on E61 for 10s until the lamps flash 5 times, clear code successfully.

ID learning button

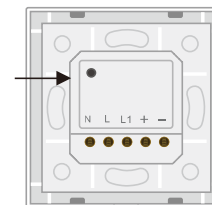

- * This manual is subject to changes without further notice. Product functions depend on the goods. Please feel free to contact our official distributors if you have any question.