

Telescopic Curtain Track Installation Manual (CURH3)

Product Description

Motorized telescopic curtain track can be adjusted in length within a specific range to suit your window size. It significantly reduces labor costs and saves time in measuring your windows and making custom-sized curtain tracks. It also effectively avoids the errors associated with manual measurement that may cause material waste. With the properties that ordinary motorized single curtain tracks have, the telescopic curtain track enables the double-sided curtains to open or close (Note: double-sided curtains are opened or closed on both sides at the same time).

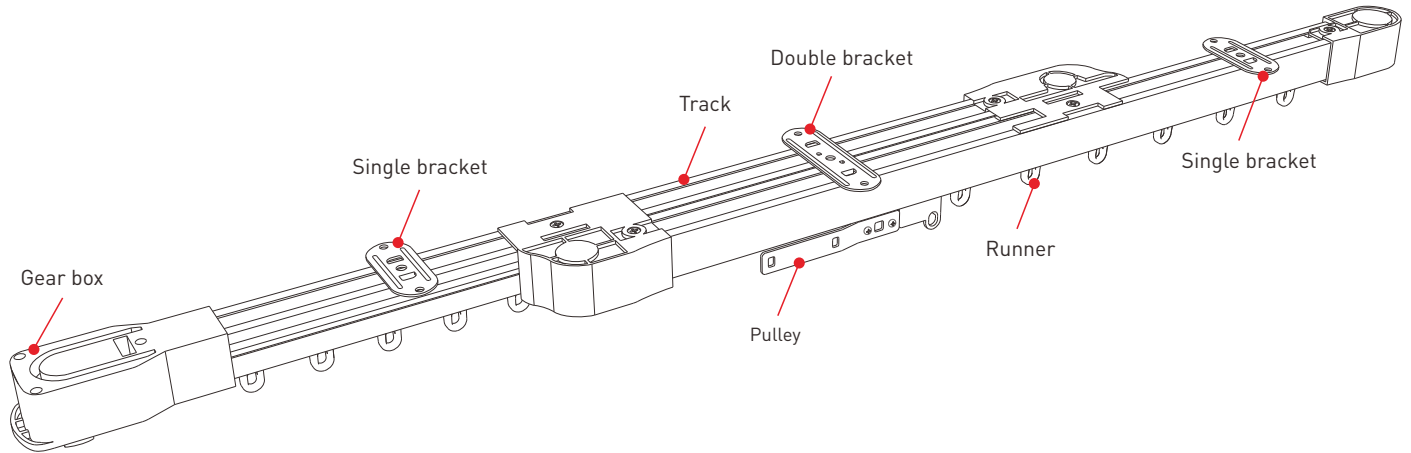

Product model	Extendable length	Dimensions	Package size	Gross weight
CURH3-180-330	180-330[cm]	L181×W6.2×H4.7[cm]	L188×W14.3×H11.6[cm]	2.3±0.5[kg]

Accessories for the telescopic track

Quantity	Name					
	Single bracket	Double bracket	Runner	Screw	Expansion bolt	Manual
CURH3-180-330	6	2	28	12	12	1

Installation Method

1.Please determine the position of the track’s gear box according to the socket position, then fix the track and finally install the motor.

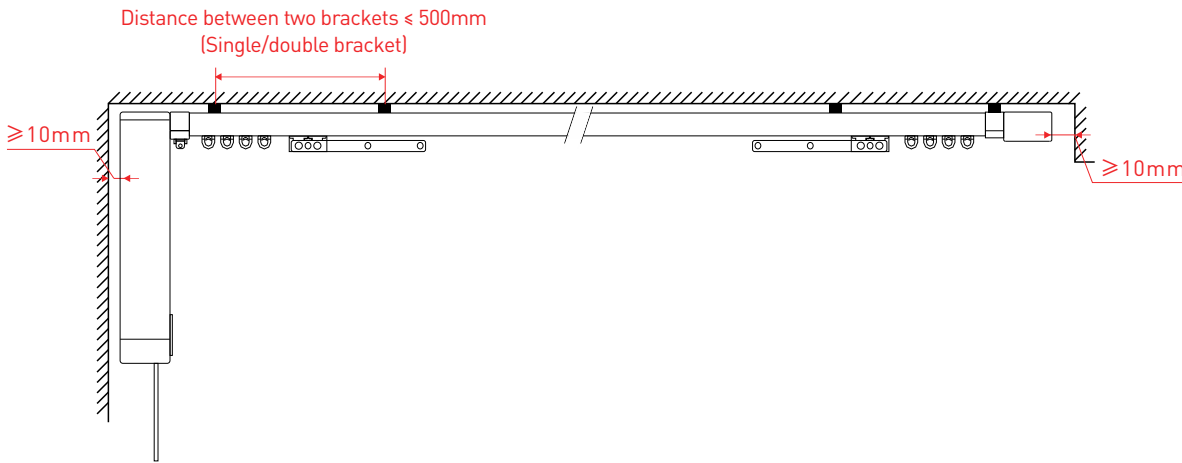

2.If you install a single curtain track, the prepared curtain box width should be no less than 100mm; If you install double curtain tracks, the prepared curtain box width should be no less than 180mm. The width can be adjusted according to the thickness and material of your curtain fabrics and your design.

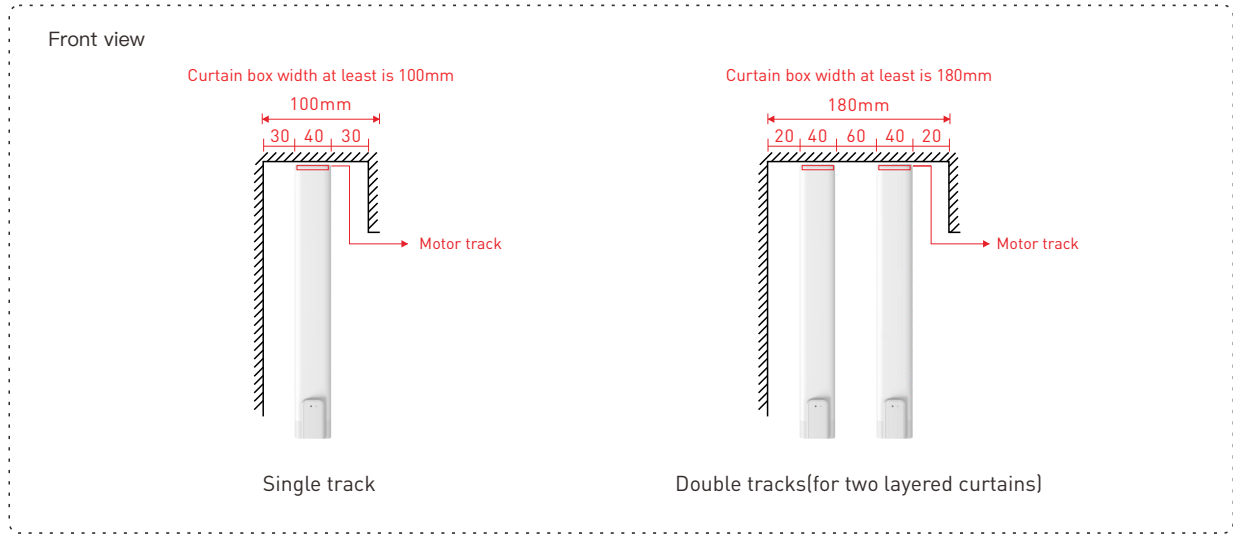

3.The default length of the curtain motor power cord is around 1 meter. If you need to extend the power cord, please prepare an extension cord on your own. And the power cord doesn’t come with a three-pole plug.

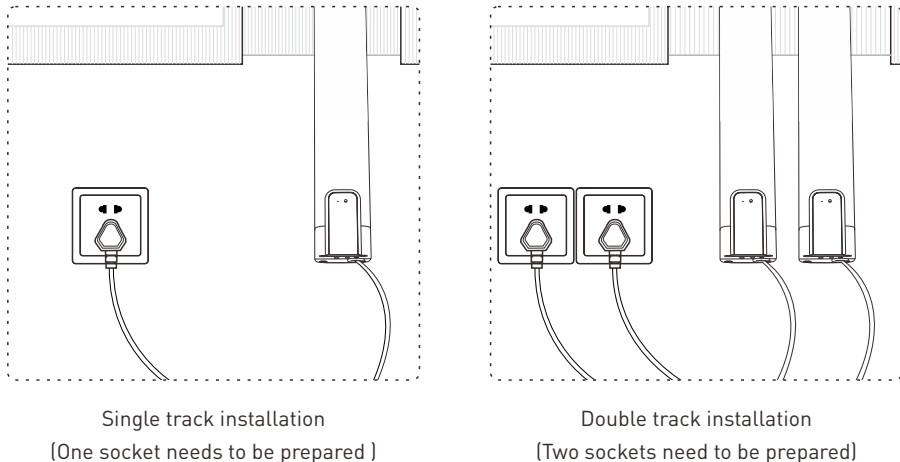

Installation Instructions

- 1. Stretch the track to the window width in the direction of the arrow. Manually move the pulley to two sides to check whether it runs smoothly.
- 2. After determining the track length, manually tighten the screws (Mark ❶ ❷ ❸) on the track to fix the track length.

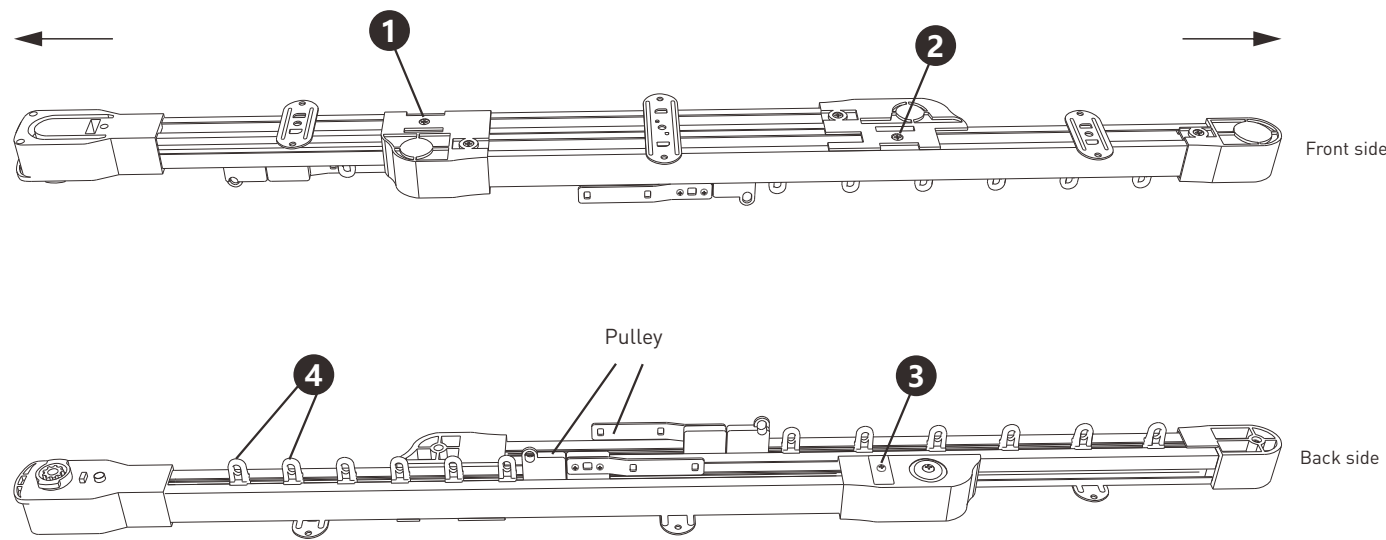

- 3. According to the number of your curtain hooks, insert the same number of runners (Mark ❹) on the both sides of the pulley. Please avoid inserting extra runners.
- 4. Move the two pulleys (Mark ❺ ❻) to both ends of the track (note: if the pulleys aren't moved to the ends, curtains won't be closed completely). Clockwise turn the screw (Mark ❼) on the slave gear box at 45 degrees. When a click sound is produced, the pulleys at both ends are locked and can be moved at the same time (To unlock them, please use the opposite operations).

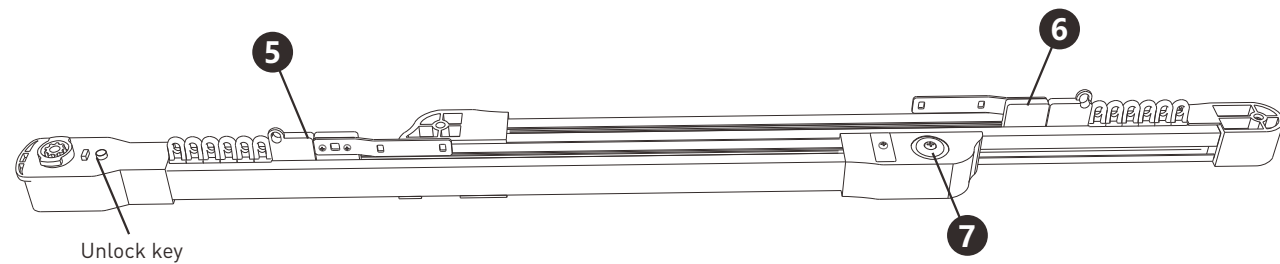

- 5. According to the track length you extend, install an appropriate number of brackets. Single bracket should be inserted around every 50 centimeters of a single track. Likewise, double bracket should be inserted around every 50 centimeters of the double tracks. After the brackets are inserted, the track pre-installation is completed.

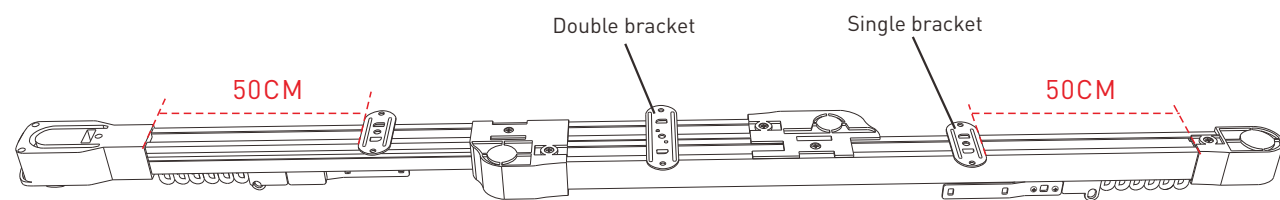

- 6. Insert the screws through the brackets and tighten the screws (Mark ❸) against the ceiling. Align the motor (Mark ❾) shaft with the hole on the gear box and insert it into the hole. Then rotate the motor to make the indicator light opposite to the unlock key. When a "click" sound is heard, it means the motor is locked. After hanging your curtains, powering on the motor and pairing it with App, you'll be able to control the curtains. (For more instructions on how to install and remove the motor, please refer to the motor manual CG-CURH3)

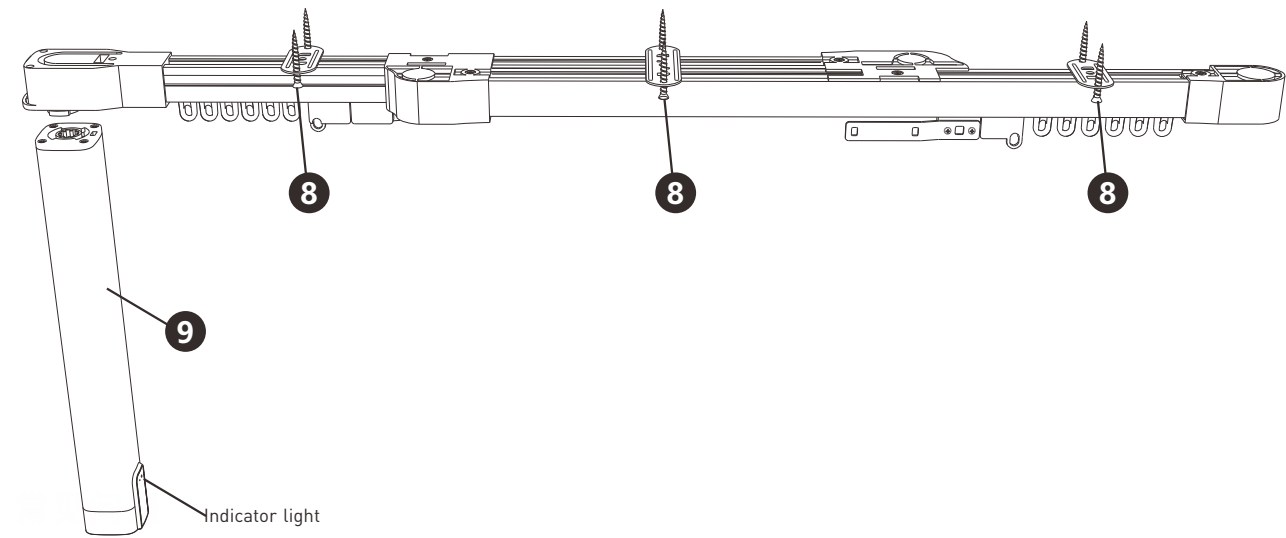

Attention

* Please do not disassemble the telescopic curtain track.

- Q1: How many sets are needed to control two layered curtains (silk curtain +fabric curtain)?
A1: Two sets are needed (two curtain motors + two curtain tracks).
- Q2: Can the motor work with other brands of curtain tracks, or can the curtain track work with other brands of motors?
A2:Our curtain motor and track can not work with other brands of tracks and curtain motors.

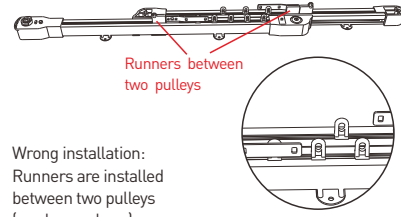
Symptom	Possible Cause	Remedy
The curtain motor and curtain track run normally when you do the commissioning on the floor, table or in other positions. But they run abnormally or make a high level of noise once installed on the ceiling.	The installation position is shifted that make the limit position of the curtain track change.	When it is powered, go to the curtain motor interface in the APP and click "Settings" - "More Settings", then click "Calibrate limit position".
In the installation process, the motor shaft has been manually rotated that changes the limit position of the curtain track.	The change in the the limit position is caused by operational mistakes.	
Please do not remove the curtain motor (detach the motor from the curtain track) unless it is necessary. If you do, the limit position of the curtain track may be changed.	The motor removal makes the limit position of the curtain track change.	
Runners are mistakenly installed between two pulleys.	 Wrong installation: Runners are installed between two pulleys (as shown above).	The number of runners that come with the curtain track is more than needed. Please install them on the both sides of the pulley (refer to the curtain track manual for detailed instructions). If the extra runners not affect the normal use, please ignore; If they do, please contact a professional personnel to remove them.