

LTECH

Super Smart Link Module

Model: CG-LINK



Manual

www.ltech-led.com

System Diagram

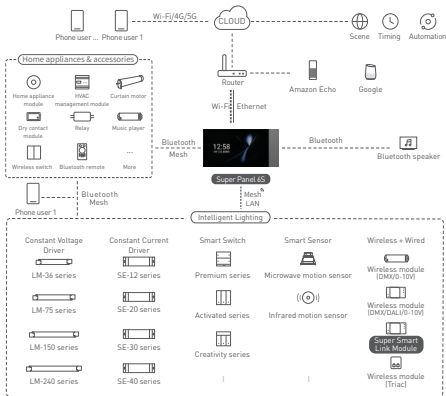

Product Features

- Small size and light weight. The housing is made from SAMSUNG/COVESTRO's V0 flame retardant PC materials.
- Bluetooth 5.0 SIG Mesh with high networking capacity provides reliable and stable performance.
- Ultra-high compatibility, can be integrated into third-party 485 control systems to expand product flexibility;
- Diversified control, support our smart home system to connect to third-party systems;
- Can record third-party 485 system commands, no input docking, convenient and efficient;
- Support local scenes, network shutdown, controllable network disconnection, faster and more stable;
- Support OTA online upgrade function, with ultra-low power consumption function, can continuously power on and off to restore factory settings;
- Independent isolation circuit, strong signal anti-interference ability, safe and stable;
- It can be used with smart gateways to realize rich cloud scenarios, cloud automation, and local automation control.

Technical Specs

Model	CG-LINK
Communication Type	Bluetooth 5.0 SIG Mesh, RS485
Operating voltage	100-240V~
485 interface	isolated
Wireless Frequency	2.4GHz
Baud Rate	1200-115200bps
Working Temperature	-20°C~55°C
Product Size	L84×W35×H23(mm)
Package Size	L100×W70×H42(mm)



RoHS

Product Image



Product size

Unit: mm

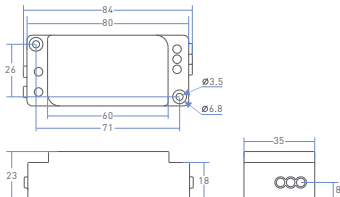

Connection application diagram

Third Party 485-LTECH Bluetooth Smart Home System



LTECH Bluetooth Smart Home System-Third Party System



Recommended Applications

1. Our equipment controls third-party equipment.



Smart Switch Super Smart Link Module Third-party 485 system

2. The third party 485 system controls our equipment.



Third-party 485 system Super Smart Link Module Bluetooth Driver Lamp

3. The third-party 485 system controls our scene.



Third-party 485 system Super Smart Link Module Local scene

4. Automation: Combined with intelligent gateway, it can realize rich automation control.



Third-party 485 system Smart Gateway Super Smart Link Module Automation

5. More applications of intelligent control are waiting for you to set up.

App Operating Instructions

1. Account Registration

Scan the QR code below with your mobile phone, follow the prompts to complete the APP installation, and then log in/register.



Scan the QR code to download the APP

2. Pairing operation

After the new user creates a family on the APP, click "+" in the upper right corner of the 【Room】 interface to add it. Select "Smart Module" - "Super Smart Connection Module" in the add device list, and follow the prompts on the interface to complete the addition.

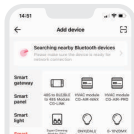
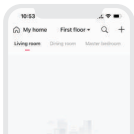

3. Add a device

Select the "Super Smart Link Module" card in the room interface, and follow the prompts to select "Custom Bluetooth to 485 Device" and Add the command "Customize 485 to Bluetooth device" and click "Save".

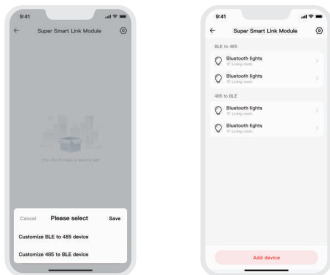

4. Scenario

Local scene:

Select "Local scene" in the **Smart** interface, and click "+" to create a local scene. Click Add action and select the corresponding device type action.

Cloud scene:

Make sure that a smart gateway has been added to the home, such as Super Panel 6S. Select "Cloud scene" in the **Smart** interface, and click "+" to create a cloud scene. Click Add action and select the corresponding device type action.

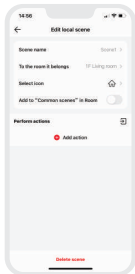

5. Automation

Make sure that a smart gateway, such as Super Panel 6S, has been added to your home. Select **Automation** in the "Smart" interface and click "+" to create automation. Set trigger conditions and execute actions. When the set trigger conditions are met, a series of device actions are automatically triggered to achieve remote linkage.

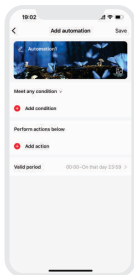
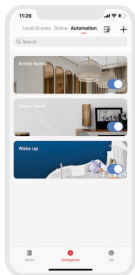

FAQs

1. What should I do if I fail to search the device via APP?

Please check below:

- 1.1 Please make sure the device is powered on normally and is in the activated state.
- 1.2 Please keep you mobile phone and device as close as possible. The recommended distance between them is no more than 15 meters.
- 1.3 Please make sure the device hasn't been added yet. If it has, please reset the device to factory defaults manually.

2. How to log in and out of the network?

- 2.1 Exit the network: Use the power switch to turn it on and off 6 times in a row (off for 5 seconds and on for 2 seconds each time).
- 2.2 Buzzer: Power on: one beep; Network access successful: one long beep; Network exit successful: three beeps;

Attentions

- Products shall be installed by qualified professionals.
- LTECH products are and not lightningproof non-waterproof (special models excepted). Please avoid the sun and rain. When installed outdoors, please ensure they are mounted in a water proof enclosure or in an area equipped with lightning protection devices.
- Good heat dissipation will extend the working life of products. Please ensure good ventilation.
- Please check if the working voltage used complies with the parameter requirements of products.
- The diameter of wire used must be able to load the light fixtures you connect and ensure the firm wiring.
- Before you power on products, please make sure all the wiring is correct in case of incorrect connection that causes damage to light fixtures.
- If a fault occurs, please do not attempt to fix products by yourself. If you have any question, please contact your suppliers.

* This manual is subject to changes without further notice. Product functions depend on the goods. Please feel free to contact our official distributors if you have any question.

Warranty Agreement

Warranty periods from the date of delivery : 2 years.

Free repair or replacement services for quality problems are provided within warranty periods.

Warranty exclusions below:

- Beyond warranty periods.
 - Any artificial damage caused by high voltage, overload, or improper operations.
 - Products with severe physical damage.
 - Damage caused by natural disasters and force majeure.
 - Warranty labels and barcodes have been damaged.
 - No any contract signed by LTECH.
1. Repair or replacement provided is the only remedy for customers. LTECH is not liable for any incidental or consequential damage unless it is within the law.
 2. LTECH has the right to amend or adjust the terms of this warranty, and release in written form shall prevail.