

# Switch Module

Model: KBS



Manual

# System Diagram

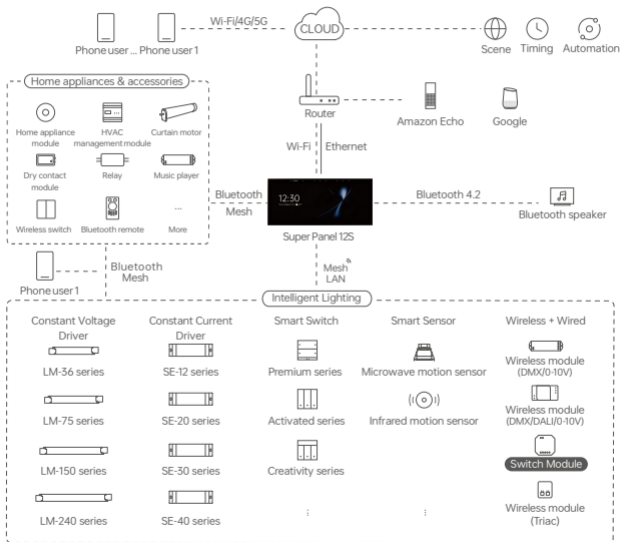

# Product Introduction

- Bluetooth 5.2 SIG Mesh communication protocol, offering strong networking capabilities, reliability, and stability.
- Equipped with dual-relay functionality, enabling control of two sets of lighting devices.
- Supports both mechanical and push switches. Even if the light is manually turned off, remote control via the APP remains available, meeting diverse needs.
- Supports OTA (Over-the-Air) online upgrades, ensuring timely feature updates and usage safety, keeping the product up-to-date.
- Supports direct connection to devices via smartphone, allowing direct control through the APP.
- Supports gateway-free control, enabling LAN remote control, wireless panels, group control, and more.
- Supports integration with a smart gateway to enable remote control of home devices, making life more convenient.
- Compact size, allowing easy installation in European, American, and national standard junction boxes, suitable for various installation scenarios.
- Supports power-off reset functionality and mechanical key reset functionality.

## Technical Specs

Model	KBS
Wireless type	Bluetooth 5.2 SIG Mesh
Switch channel	2CH
Operating voltage	100-240V~, 50/60Hz, $\mu$
Max. load current of the relay	10A
Max. load parameters of the relay	Resistive load: 1000W@230Vac/CH, 500W@110Vac/CH, Max.2000W Capacitive load: 400W@230Vac/CH, 200W@110Vac/CH, Max.800W
Relay surge current	70A@10ms
Working temperature	-25°C~50°C
Product size	L45*W45.5*H20.5(mm)
Product weight	30g
Standards	UL 8750、EN 61347-2-13:2014+A1:2017、EN 61347-1:2015+A1:2021、 EN 62493:2015/A1:2022

## Product Images

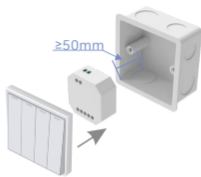
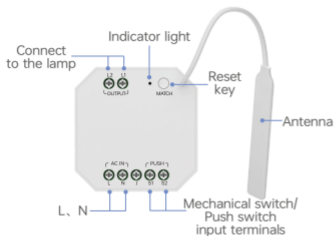

Hide this product inside a switch box.  
\*Requires installation in a box with a depth of  $\geq 50\text{mm}$

## Product Size

Unit: mm

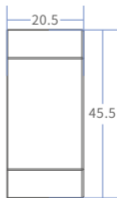
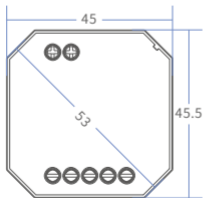

# Wiring Diagram

1. Two mechanical switches control one relay each.

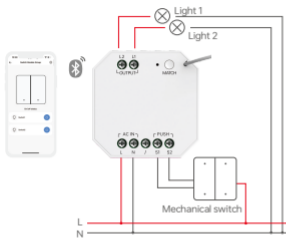

2. One mechanical switch controls two relays.

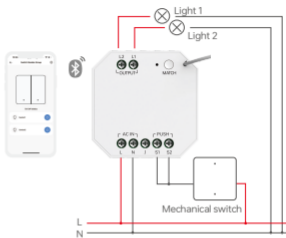

3. Two push switches control one relay each.

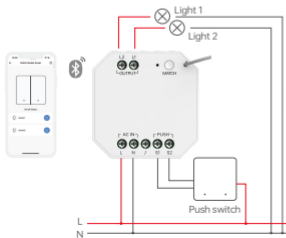

4. One push switch controls two relays.

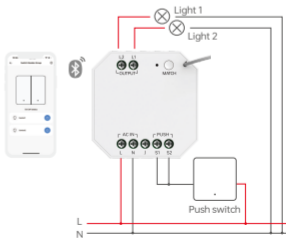

# Recommended Applications

## 1. Wireless light control



2. After setting up the remote control association with the switch module via the APP, both the APP and the remote control can be used to control the device.

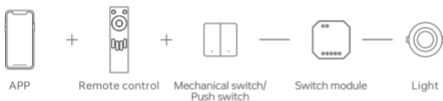

3. Supports local scenes, gateway-free operation, and controllable even when offline.



4. Work with intelligent gateway, it can realize visual control, cloud scene and automatic linkage.



5. ...Intelligent control. Set up more app configs as you like.

# App Operating Instructions

## 1. Register an account

Scan the QR code below with you mobile phone and follow the prompts to complete the app installation.



Scan code download APP  
IOS/Android

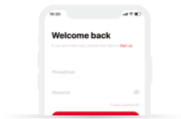

## 2. Parameter setting

More settings such as editable binding interface, group control, local scenes, cloud scenes, and automation.

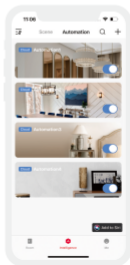
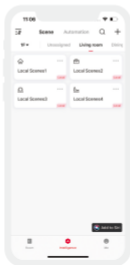

### 3. Binding interface settings

After pairing is completed, enter the binding interface for the smart remote control/smart wireless switch. Select the switch module device to associate it, and then you can control the device's on/off function using the smart remote control/smart wireless switch. You can also unbind the device from this interface.

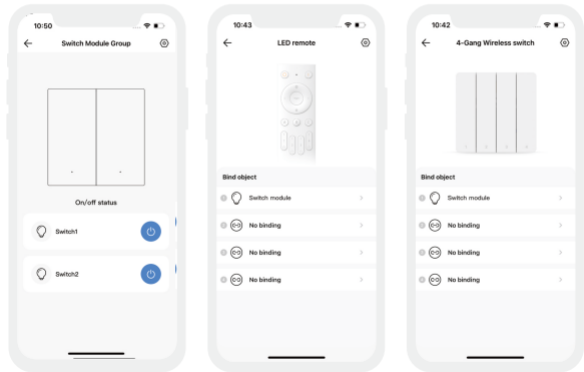

## 4. Light fixture group

The same type of lighting fixtures can be grouped together, allowing users to control power on/off and other operations for the entire group, making operations more convenient. Switch to the "Group" menu, click the "+" icon in the upper right corner, follow the prompts to modify the group name, then click "Next," select the devices you want to include in the group, and save.

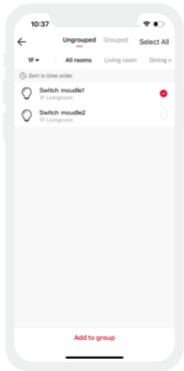
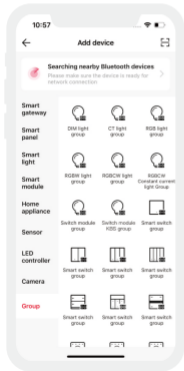

## 5. Local scene

Switch to the **【Smart】** page, click "+" in the upper right corner to create a local scene, and after setting the execution action, you can realize the local linkage of Bluetooth devices.

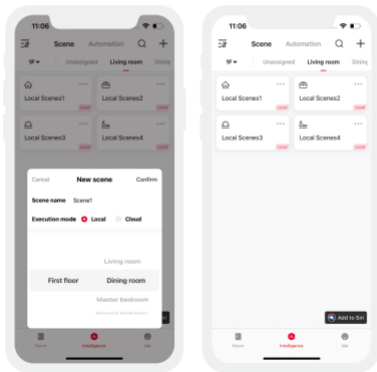

## 6. Cloud scenes and automation

Make sure that a smart gateway, such as SP-GW-6S, has been added to the family.

**Cloud scenes:** Switch to the **【Smart】** interface and click "+" to create a cloud scene. After setting the execution action, remote linkage can be achieved.

**Automation:** Select "Automation" in the **【Smart】** page and click "+" to create automation. You can choose local/cloud execution mode, and set trigger conditions and execution actions. When the set trigger conditions are met, a series of device actions are automatically triggered to achieve remote linkage

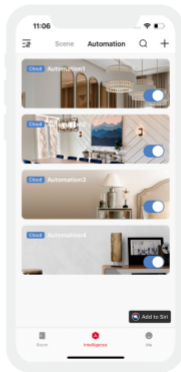
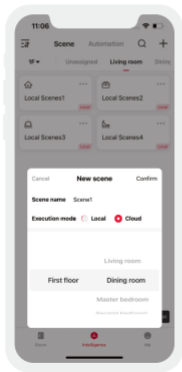

# Reset To Factory Defaults

**Mechanical Reset:** Connect device to lighting fixture. Hold reset button for 15s until indicator light flashes red rapidly, then release. Press reset button 3 times briefly within 3s. Slow red flash means factory settings restored; rapid blue flash means setup is complete.

**Power Cycle Reset:** With power off, switch device on for 15s then off. Repeat power on/off 6 times (2s on, 5s off each). On 7th power-on, connected fixture blinks 3 times, showing factory settings restored.

**APP Reset:** Click the "... " on the switch module to enter the main interface, then click the "⊙" in the upper right corner to access the settings interface. Click "Delete Device" to complete the reset.

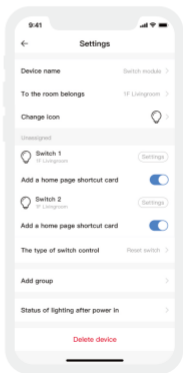
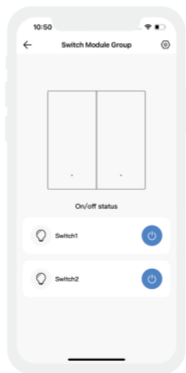
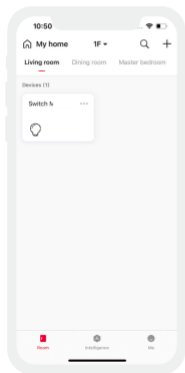

# FCC Statement

1. This device complies with Part 15 of the FCC Rules. Operation is subject to the following two conditions:

(1) This device may not cause harmful interference.

(2) This device must accept any interference received, including interference that may cause undesired operation.

2. Changes or modifications not expressly approved by the party responsible for compliance could void the user's authority to operate the equipment.

Note: This equipment has been tested and found to comply with the limits for a class B digital device, pursuant to Part 15 of the FCC Rules. These limits are designed to provide reasonable protection against harmful interference in a residential installation.

This equipment generates uses and can radiate radio frequency energy and, if not installed and used in accordance with the instructions, may cause harmful interference to radio communications. However, there is no guarantee that interference will not occur in a particular installation. If this equipment does cause harmful interference to radio or television reception, which can be determined by turning the equipment off and on, the user is encouraged to try to correct the interference by one or more of the following measures:

- Reorient or relocate the receiving antenna.
- Increase the separation between the equipment and receiver.
- Connect the equipment into an outlet on a circuit different from that to which the receiver is connected.
- Consult the dealer or an experienced radio/TV technician for help.

The device has been evaluated to meet general RF exposure requirement. This equipment should be installed and operated with a minimum distance of 20 cm between the radiator and your body.

## FAQ

### What should I do if the device cannot be found during the search?

Please check the following options:

- Ensure the device is powered on and functioning properly.
- Ensure the phone and the device are as close as possible, preferably within 15 meters.
- Ensure the device has not been added before. If it has, please manually restore it to factory settings.

## Attention

- Product installation and commissioning should be done by a qualified professional.
- Our company products are and not lightningproof non-waterproof(special models excepted). Please avoid the sun and rain. When installed outdoors, please ensure they are mounted in a water proof enclosure or in an area equipped with lightning protection devices
- Good heat dissipation will prolong the working life of products. Please ensure good ventilation.
- Please check if the working voltage used complies with the parameter requirements of products.
- The diameter of wire used must be able to load the light fixtures you connect and ensure the firm wiring.
- Before you power on products, please make sure all the wiring is correct in case of incorrect connection that causes damage to light fixtures.
- If a fault occurs, please do not attempt to fix products by yourself. If you have any question, please contact your suppliers.

# Warranty Agreement

- Warranty periods from the date of delivery: 5 years.
- Free repair or replacement services for quality problems are provided within warranty periods.

Warranty exclusions below:

Following conditions are not within the guarantee range of free repairing or replacement services:

- Beyond warranty periods.
  - Any artificial damage caused by high voltage, overload, or improper operations.
  - Products with severe physical damage.
  - Damage caused by natural disasters and force majeure.
  - Warranty labels and barcodes have been damaged.
  - No any contract signed by our company.
1. Repair or replacement provided is the only remedy for customers. Our company is not liable for any incidental or consequential damage unless it is within the law.
  2. Our company has the right to amend or adjust the terms of this warranty, and release in written form shall prevail.
- \* This manual is subject to changes without further notice. Product functions depend on the goods. Please feel free to contact our official distributors if you have any question.