

Xiaolei

Super Smart Switch

(1-Gang / 2-Gang / 3-Gang / 4-Gang)



Manual

www.xiaolei.com.cn

System Diagram

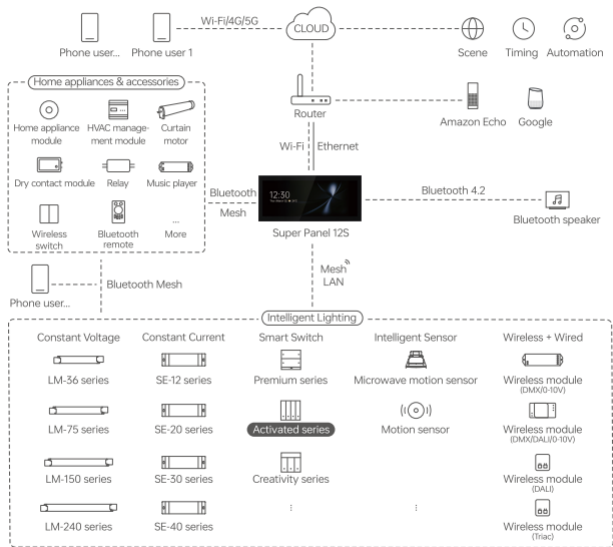

Product Features

- Act as a relay with Bluetooth 5.0 SIG Mesh, turning traditional lamps into smart ones.
- Support panel grouping that allows you to control multiple panels simultaneously.
- Work with a Bluetooth LED driver to turn lights on/off and change brightness or colors of lights.
- Work with a gateway device to achieve various cloud scenes and automation.
- Support local scenes that can still run without the Internet or a gateway. Faster and more stable.
- Designed with 86 type junction box. Available in 400+ combinations of switch panels with unified panel surrounds.

Technical Specs

Model	S1	S2	S3	S4
Wireless Type	Bluetooth 5.0 SIG Mesh			
Power Supply	Null and live line powered			
Rated Parameter	100-240V~, 50/60Hz, μ			
Maximum Current	$\leq 10A$			
Single Load	LED $\leq 200W$, $\odot \leq 400W$			LED $\leq 300W$, $\odot \leq 600W$
Channel of Load	1 CH	2 CH	3 CH	4 CH
Inrush Current in Loads	Max. 65A@2ms			
Working Temperature	-20°C~55°C, Humidity $\leq 80\%RH$			
Net Weight	160g	168g	175g	177g
Dimensions	86×86×40mm (L×W×H)			
Colors Available	Grey, Gold, White			



RoHS

Product Images

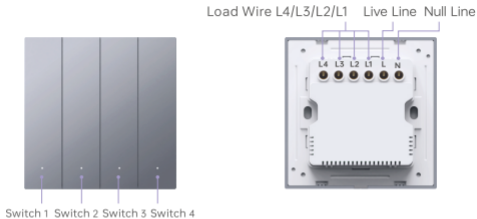

Product Size

Unit: mm

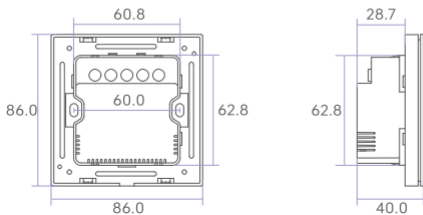

Installation Steps

- ① Turn off the circuit breaker and remove any concrete or corrosion that are inside the 86 type wall box. Trim each power cord wire in the wall box to about 10cm in length. Pry the switch plate up with a flat head screwdriver.



- ② Attach the live line to L socket of the switch and the null line to N socket, and the load wire to L1/L2/L3/L4 socket. Make sure the wires are well connected to the switch terminals with no copper wire exposed. (The protection device for the electronic switch cannot be greater than 35A)

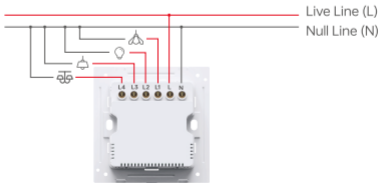

- ③ Insert the screws into the hole on two sides of the switch and secure the screws to fit the switch to the wall with a screwdriver.

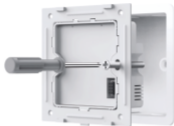

- ④ Slant the switch plate and put it in place. Finally, turn on the circuit breaker and press any key of the switch. If the light can be controlled normally, it means the switch has been installed correctly.



Step 1: Snap the switch plate down

Step 2: Snap on the switch plate on the bottom

Note: If you want to install multiple panels into one row, please refer to the relevant manual for detailed instructions

Recommended Applications

1. Connect to traditional lamps and turn them into smart ones.

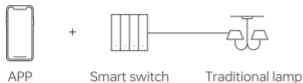

2. Work with a Bluetooth LED driver to wirelessly control lamps.

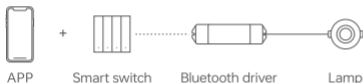

3. Support local scenes that can still run without the Internet or a gateway.

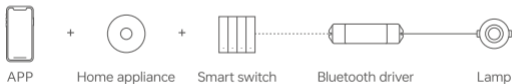

4. Work with a smart gateway to realize visual control and automation.



5. More applications of intelligent control are waiting for you to set up.

App Operating Instructions

1. Register an account

Scan the QR code below with you mobile phone and follow the prompts to complete the app installation. Then open the App and log in or register an account.



Scan and download the App

2. Connect to the network

Create a home if you are a new App user. Click **[+]** icon in the upper right corner of “Room” interface to access “Add device” list. Pick **[Smart switch]** and follow the on-screen prompts to add the device.

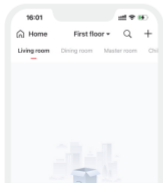

3. Create a panel group

Click **[+]** icon in the upper right corner of “Room” interface to access “Add device” list. Pick **[Group-Smart switch group]** . Create a smart switch group, then rename the group and set up the room it belongs to. Pick devices you want to add to the group. Once the group is created, the data of sub devices will be synchronized with other switches in this group. So you can control the group devices simultaneously.

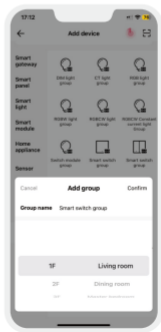

4. Bind a device

In “Room” interface, click the smart switch you have added to access its control interface.

Switch to **【Room】** interface and click the smart switch you have added to access its control interface.

Long press the switch button on the screen you want to bind. Or switch to “Key Settings” and select a binding device by clicking **【Device】** , then set up the action on this switch button, then save your setting.

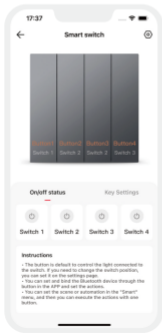

5. Local scene

Create a local scene:

Switch to “Intelligence” interface and click **【 + 】** icon in the upper right corner to add a local scene. After you set up the action performed in this scene, the local linkage with the Bluetooth device can be achieved.

Bind a local scene:

click the smart switch you have added to access its control interface.

Long press the switch button on the screen you want to bind. Or switch to “Key Settings” and select a binding device by clicking **【Scene】** , then set up the action on this switch button, then save your setting.

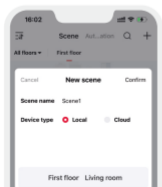

Create a local scene

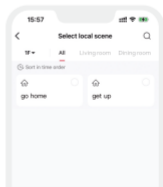

Bind a local scene

6. Cloud scene and automation

Please be sure a smart gateway device is added to your home, such as Super Panel 12S. Cloud scene:

Switch to “Intelligence” interface and click 【 + 】 icon in the upper right corner to add a cloud scene. After you set up the action performed in this cloud scene, the remote linkage can be achieved.

Automation:

Tap 【Automation】 in “Intelligence” interface and click 【 + 】 icon to create automation. You can choose local or cloud execution option, then set the trigger conditions and executing action. When the conditions you set are met, a series of device actions will be automatically triggered to perform and remote linkage is achieved as well.

Note: You can set the smart switch to act as the trigger condition and as the executing action.

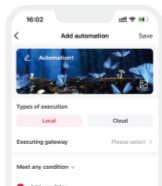
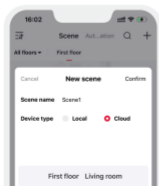

FAQs

1. How to reset a switch to factory defaults?

Long press the rightmost switch for 15s (S1=only switch, S2=second switch, S3=third switch, S4=fourth switch) and release it until all the indicator lights flash fast. Within 3s, short press the same switch 3 times and the indicator light flashes slowly, which means the switch has been reset to factory defaults.

2. What should I do if I fail to search the device via APP?

Please check below:

- Please make sure the device is powered on normally and is in the activated state.
- Please keep you mobile phone and device as close as possible. The recommended distance between them is no more than 15 meters.
- Please make sure the device hasn't been added yet. If it has, please reset the device to factory defaults manually.

Attentions

- Products shall be installed by qualified professionals
- LTECH products are and not lightningproof non-waterproof (special models excepted). Please avoid the sun and rain. When installed outdoors, please ensure they are mounted in a water proof enclosure or in an area equipped with lightning protection devices.
- Good heat dissipation will prolong the working life of products. Please ensure good ventilation.
- Please check if the working voltage used complies with the parameter requirements of products.
- The diameter of wire used must be able to load the light fixtures you connect and ensure the firm wiring.
- Before you power on products, please make sure all the wiring is correct in case of incorrect connection that causes damage to light fixtures.
- If a fault occurs, please do not attempt to fix products by yourself. If you have any question, please contact your suppliers.

Warranty Agreement

- Warranty periods from the date of delivery: 2 years.
- Free repair or replacement services for quality problems are provided within warranty periods.

Warranty exclusions below:

- Beyond warranty periods.
- Any artificial damage caused by high voltage, overload, or improper operations.
- Products with severe physical damage.
- Damage caused by natural disasters and force majeure.
- Warranty labels and barcodes have been damaged.
- No any contract signed by LTECH.

1. Repair or replacement provided is the only remedy for customers. LTECH is not liable for any incidental or consequential damage unless it is within the law.
2. LTECH has the right to amend or adjust the terms of this warranty, and release in written form shall prevail.

* This manual is subject to changes without further notice. Product functions depend on the goods. Please feel free to contact our official distributors if you have any question.