

LTECH

Super Panel PRO

Manual
www.ltech-led.com

 Bluetooth®   RoHS

System Diagram

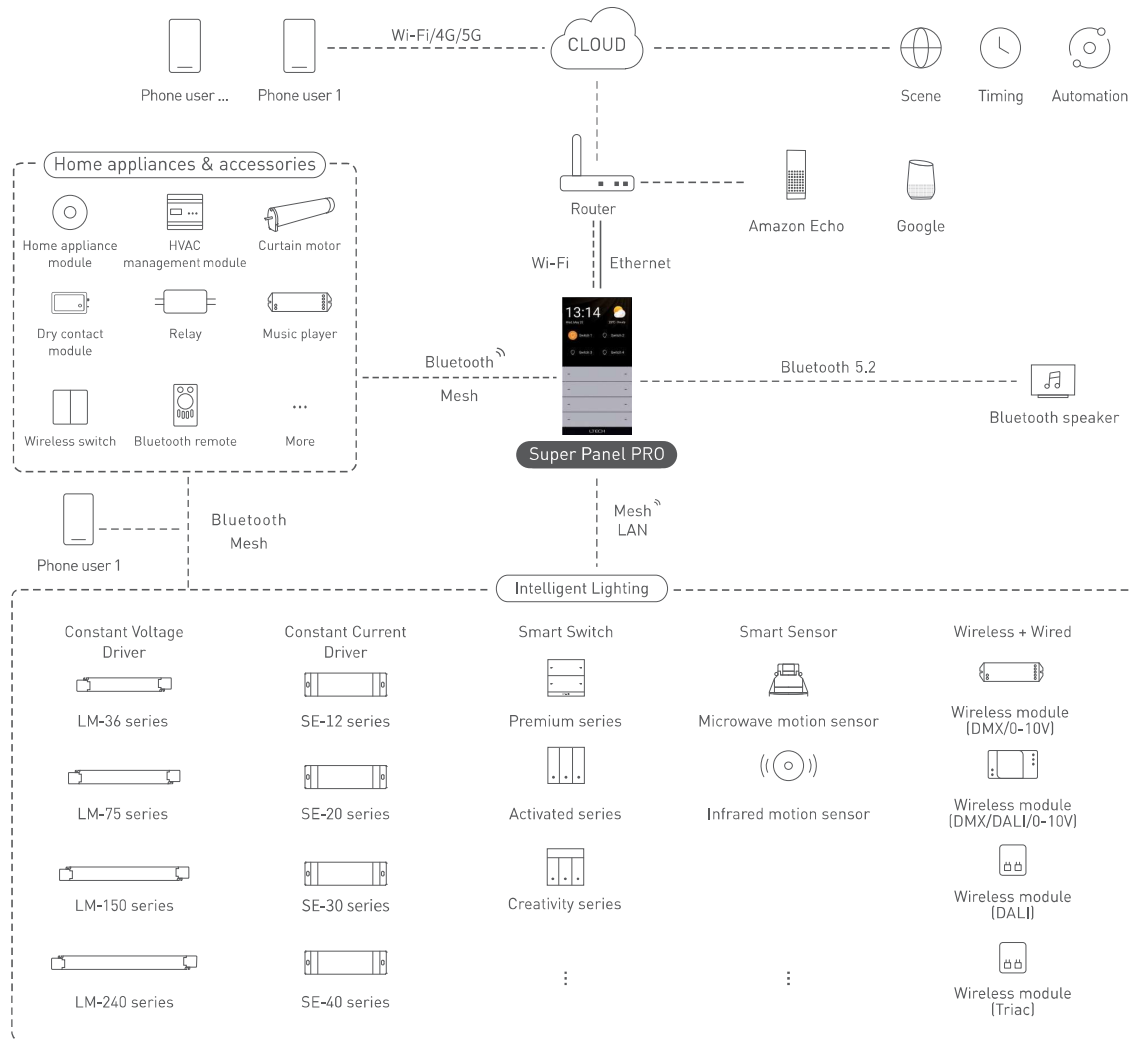

Welcome to Super Panel PRO

Super Panel PRO is a whole house smart central control panel, featuring a large HD touch screen with 720×720 resolution. It is compatible with dual-band Wi-Fi (2.4 GHz and 5.0 GHz Wi-Fi). It supports connection with smart devices via Bluetooth 5.0 SIG Mesh, as well as connection with smart speakers via Bluetooth 5.2 protocol to achieve whole-house smart device linkage. Additionally, it supports direct infrared home appliance connection and voice calls to enrich our smart ecosystem. Super Panel PRO comes with 8 buttons, 4 of which on the whole can act as a 4 channel relay to directly connect with traditional lamps. The App allows you to bind a device action/scene to each button so as to control the entire smart home from one single panel. It combines button, touchscreen and App interaction together. Multiple pre-defined living scenes can be turned on /off by just a button.

Super Panel PRO has a two omnidirectional microphone array and a built-in 2-in-1 light and proximity sensor that enables auto screen brightness adjustment as well as auto screen wake up when nearby people approach it.

Technical Specs

Model	SP-GW-PRO
Wireless network	Bluetooth 5.0 SIG Mesh, Wi-Fi 2.4G+5G, BLE 5.2
Power supply	100-240V~, 50/60Hz μ
Display	4-inch full lamination, 720×720 resolution
Microphone	Two omnidirectional microphone array
Touchpad	Capacitive multi-touch screen, anti-fingerprint coating
Speaker	AAC 1151 speaker
Materials	Aviation aluminum,CNC machining techniques, PC + fiberglass, V0 fireproofing grade
Roximity sensor	Close-range sensing within 30cm, automatic wakeup
Light sensor	Adjust screen brightness automatically when lighting changes
Single load	LED≤300W, Φ ≤600W
Channel of load	4 Channels
Inrush current in loads	Max.65A@2ms
Working environment	-15°C~50°C, Humidity≤85%RH
Dimensions	L172×W86×H39.5[mm]
Package size	L218×W132×H75[mm]
Net Weight	380g
Junction box	86 type
Colors Available	Silver, Gold, Grey, Pink

Package Contents

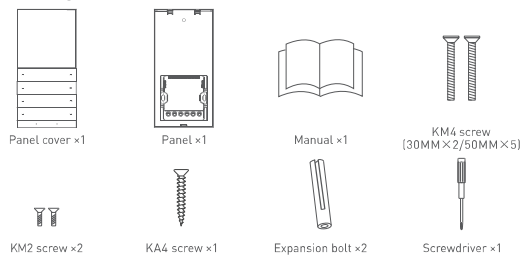

Recommended Applications

1. Gain fast control of the lamp through the APP.

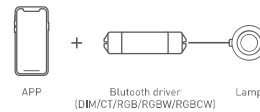

2. Connect Super Panel PRO to a traditional lamp and to the APP, so you can intelligently control the lamp.

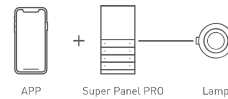

3. Wireless + wired control (Enriching different lighting applications).

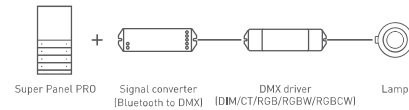

4. Super Panel PRO supports both LAN + remote lighting control via 4G/5G/Wi-Fi.

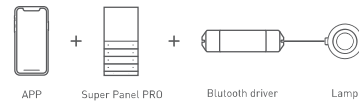

5. The Super Panel PRO and home appliance module control lamps, air conditioning, curtains and other items (Customize cloud scenes and automatic applications)

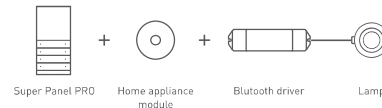

6. The Super Panel PRO, remote and wireless switch can simultaneously control lamps.

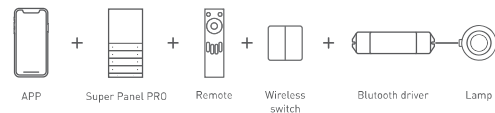

7. More applications of intelligent control are waiting for you to set up.

Product Overview

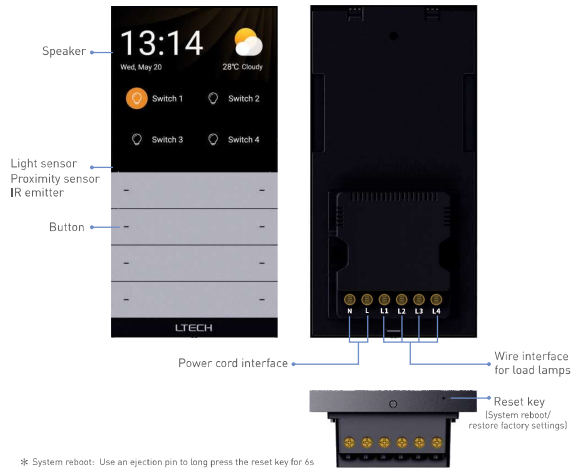

* System reboot: Use an ejection pin to long press the reset key for 6s and release it until the LOGO is displayed on the screen, then wait for the system to restart.
Restore factory settings: Use an ejection pin to long press the reset key for 6s and release it until the LOGO is displayed on the screen, Within 30s, press the reset key again for 6s and wait for the system to restart.

Product Size

Unit: mm

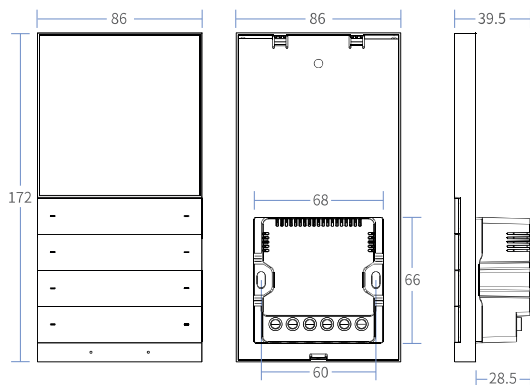

5

Installation Steps

1 Turn off the circuit breaker and remove any concrete or corrosion that are inside the 86 type wall box. Trim each wire in the wall box to about 10cm in length.

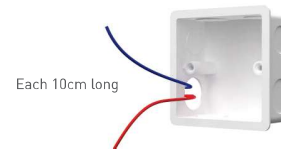

2 Wire the panel

Attach the live line to L socket of the panel, the null line to N socket and the load wires of the lights to L1/L2/L3/L4 port. Make sure the wires are well connected to the switch terminals with no copper wire exposed. (The protection device for the electronic switch cannot be greater than 35A)

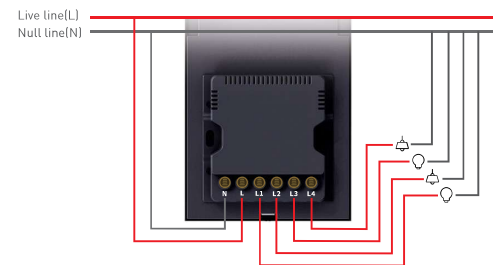

3 Install the panel

Mark the position of the KA4 screw hole on the wall first and drill a hole, then insert the expansion bolt into this screw hole. Place the KA4 screw into the bolt through the panel frame and secure the screw to fit the panel frame to the wall with a screwdriver; Next use KM4 screws to secure the panel box to the wall box.

Note: Make sure the panel frame is stable and won't appear crooked.



6

4.Snap on the panel cover

Slant the bottom of Super Panel PRO cover and snap it to the panel frame, as shown below. Then secure the Super Panel PRO cover to the frame from the bottom with a KM2 screw.



|| KM2 screw

Instructions to use Super Panel PRO

1. Swipe gesture control

- ① After devices and scenes are added to Super Panel PRO, the system will automatically generate different types of pages. You'll be able to swipe left and right to switch to any device page.
- ② Swipe down from the top of screen to access the control center; swipe up to close it.
- ③ Swipe up from the bottom of screen to access the button usage guidelines; swipe down to close it.

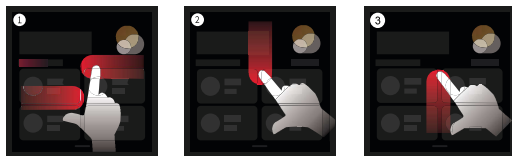

2.Physical buttons

There are eight physical buttons on the panel. The first four physical buttons are used to control relays by default. The App allows you to bind a device action/scene to each button. For more details, please refer to P12. You'll be able to swipe up from the bottom of screen to go to the button usage guidelines and view the functionality of each button; swiping down lets it close.

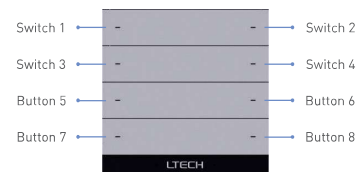

App Operating Instructions

1. Register an account

- 1.1 Scan the QR code below with you mobile phone and follow the prompts to complete the app installation.



Scan and download the App

- 1.2 Open the App and log in or register an account.

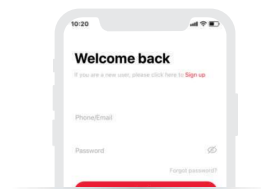

2. Configure the Super Panel PRO

Power on the Super Panel PRO and wait for a while to start it. Follow the page guidelines of panel to connect the Wi-Fi. Once connected successfully, a QR code for the device will be displayed on the interface and you'll be able to complete the configuration.



3. Bind your account

Create a home if you are a new user. Then click "+" icon in the upper right corner to access the "Add device" page. Pick "Smart gateway-Super Panel PRO" from the device list and follow the prompts to scan the QR code displayed on the Super Panel PRO screen, then complete your account binding.

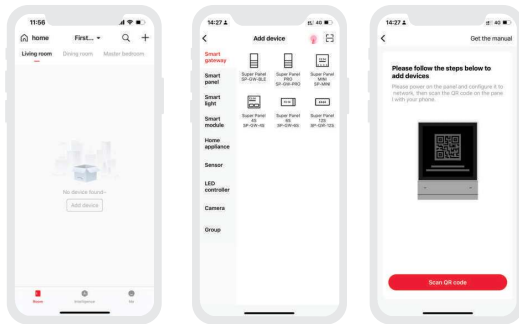

9

4. Add infrared devices

Go to the Super Panel PRO interface and click "IR appliance", then tap "+" icon in the upper right corner. Follow the prompts in APP to select your infrared home appliances according to the appliance type and brand. After completing the setting, you can directly control the infrared home appliances with the Super Panel PRO.

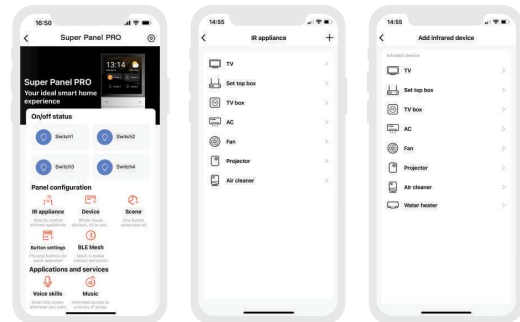

5. Control devices with the Super Panel PRO

Please refer to manuals of related products. Follow the prompts to add the devices you want and access the Super Panel PRO interface. Click "Device" to go to "Display devices" interface. Then click the icon in the upper right corner to pick the devices you want to control with the Super Panel PRO and save them.

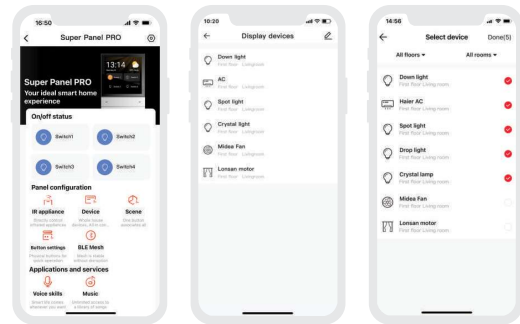

10

6. Control scenes with the Super Panel PRO

Create scenes: Get back to the homepage of the App. Switch to "Intelligence" menu and click "+" icon to add scenes. Follow prompts to modify names and icons for scenes, and click "Add action" to set up the action and delay time you want.

Display scenes: Go to the Super Panel PRO interface and click "Scene" to access "Display Scenes" interface. Click the icon in the upper right corner to add the scenes you want to control with the Super Panel PRO.

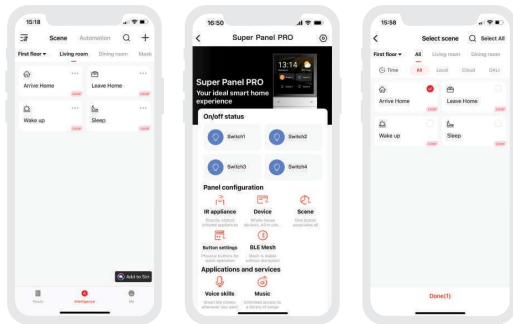

7. Set up the relay

In the "Room" interface, click the blank area of the Super Panel PRO card to get a popup and control Switch 1/Switch 2/Switch 3/Switch 4 quickly. Or you can go to Super Panel PRO interface to turn on/off the 4 channel relay by tapping Switch 1/Switch 2/Switch 3/Switch 4. Go to the Super Panel PRO settings and click the corresponding button to name the relay.

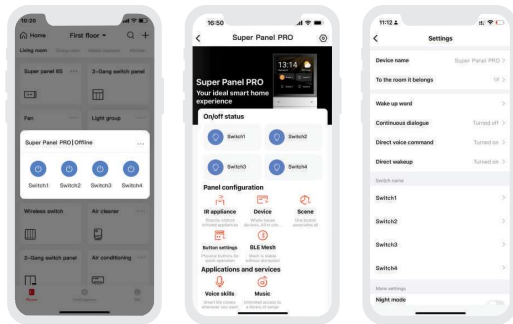

11

8. Set up the physical buttons

Go to the Super Panel PRO interface and click "Button settings". Tap the button you want and follow the prompts to set up the device action or scene performed by this button.

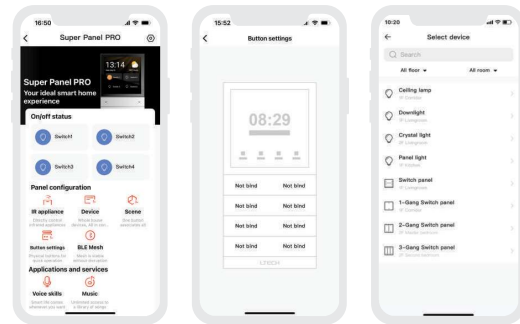

9. Voice intercom function

Voice intercom: Switch to the [Intelligence] menu and click "Voice intercom" to enter the interface of "Display device". At the top right, click "Manage", then follow the prompts to set up voice intercom. Make voice intercoms to the APP on Super Panel PRO and vice versa. You can also make voice intercoms to or on other smart gateways/communication devices in your home.

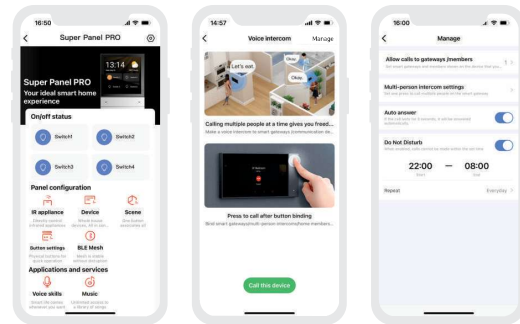

12

FAQs

1.How to change the user account?

Super Panel PRO has one standard user account only. The Super Panel PRO that has been added needs to be deleted with the APP before your login.

2.How to restart the device?

Use an ejection pin to long press the reset key for 6s and release it until the LOGO is displayed on the screen, then wait for the system to restart.

3.How to reset the device to factory defaults?

Use an ejection pin to long press the reset key for 6s and release it until the LOGO is displayed on the screen. Within 30s, press the reset key again for 6s. When the system restarts, it means the device has been reset to factory defaults.

Attentions

- Product installation and commissioning should be done by a qualified professional.
- LTECH products are non-waterproof and not lightningproof (special models excepted). Please avoid the sun and rain. When installed outdoors, please ensure they are mounted in a water proof enclosure or in an area equipped with lightning protection devices.
- Good heat dissipation will extend the working life of products. Please ensure good ventilation.
- Please check if the working voltage used complies with the parameter requirements of products.
- The diameter of wire used must be able to load the light fixtures you connect and ensure the firm wiring.
- Before you power on products, please make sure all the wiring is correct in case of incorrect connection that causes damage to light fixtures.
- If a fault occurs, please do not attempt to fix products by yourself. If you have any question, please contact your suppliers.

* This manual is subject to changes without further notice. Product functions depend on the goods. Please feel free to contact our official distributors if you have any question.

Warranty Agreement

Warranty periods from the date of delivery : 2 years.

Free repair or replacement services for quality problems are provided within warranty periods.

Warranty exclusions below:

- Beyond warranty periods.
- Any artificial damage caused by high voltage, overload, or improper operations.
- Products with severe physical damage.
- Damage caused by natural disasters and force majeure.
- Warranty labels and barcodes have been damaged.
- No any contract signed by LTECH.

1. Repair or replacement provided is the only remedy for customers. LTECH is not liable for any incidental or consequential damage unless it is within the law.
2. LTECH has the right to amend or adjust the terms of this warranty, and release in written form shall prevail.



www.ltech-led.com

ZHUHAI LTECH TECHNOLOGY CO., LTD.

1st Building, No. 183, Shui'an 1st Road, Xiangzhou District,
519060 Zhuhai City, PEOPLE'S REPUBLIC OF CHINA